

## Product Catalog

Please call us for ordering assistance, or you can print and fill out this order form and include your customer information on the following page and e-mail or fax it to us. Contact us for customized product designs at quoted pricing. Prices are subject to change without notice.

### STRUT NUT

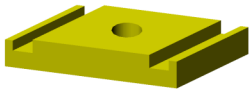

PART NO.	PRICE EACH	QTY.
SN-00	\$ 4.00	

### MOUNTING RAIL

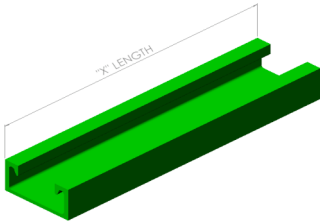

Longer lengths are available.

PART NO.	PRICE EACH.	QTY.
MR-X (in)		
MR-12	\$ 9.00	
MR-24	\$ 12.00	
MR-36	\$ 16.00	
MR-48	\$ 20.00	
MR-60	\$ 25.00	

### ROTARY BRACKET HARDWARE KIT

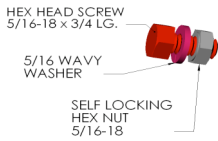

PART NO.	PRICE EACH	QTY.
RTB-HW	\$ 1.25	

### STRUT NUT HARDWARE KIT



PART NO.	PRICE EACH	QTY.
SN-HW	\$ 1.00	

### FLAT BRACKET

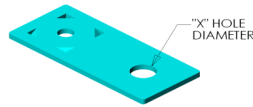

PART NO.	PRICE EACH	QTY.
FBH-X (mm)		
FBH-BLK	\$ 3.00	
FBH-8	\$ 3.50	
FBH-10	\$ 3.50	
FBH-12	\$ 3.50	
FBH-20	\$ 3.50	

### FLAT BRACKET (WITH SLOT)

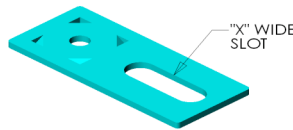

PART NO.	PRICE EACH	QTY.
FBS-X (mm)		
FBS-8	\$ 4.00	
FBS-10	\$ 4.00	
FBS-12	\$ 4.00	
FBS-20	\$ 4.00	

### ANGLE BRACKET

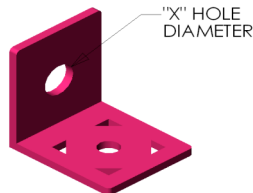

PART NO.	PRICE EACH	QTY.
ABH-X (mm)		
ABH-BLK	\$ 4.50	
ABH-8	\$ 5.00	
ABH-10	\$ 5.00	
ABH-12	\$ 5.00	
ABH-20	\$ 5.00	

### ROTARY BRACKET

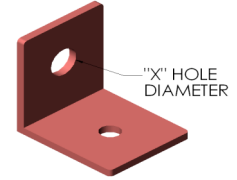

PART NO.	PRICE EACH	QTY.
RBH-X (mm)		
RBH-8	\$ 4.50	
RBH-10	\$ 4.50	
RBH-12	\$ 4.50	
RBH-20	\$ 4.50	

### ROTARY BRACKET (WITH SLOT)

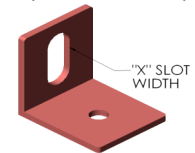

PART NO.	PRICE EACH	QTY.
RBS-X (mm)		
RBS-8	\$ 5.00	
RBS-10	\$ 5.00	
RBS-12	\$ 5.00	
RBS-20	\$ 5.00	

### ROTARY TILT BRACKET

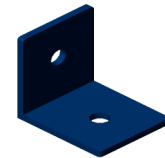

PART NO.	PRICE EACH	QTY.
RTB	\$ 4.00	

### ANGLE BRACKET (WITH SLOT)

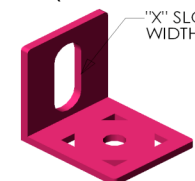

PART NO.	PRICE EACH	QTY.
ABS-X (mm)		
ABS-8	\$ 6.00	
ABS-10	\$ 6.00	
ABS-12	\$ 6.00	
ABS-20	\$ 6.00	

**Bill To:**  
 Name: \_\_\_\_\_  
 Company: \_\_\_\_\_  
 Address: \_\_\_\_\_  
 City, State, Zip: \_\_\_\_\_  
 Phone: \_\_\_\_\_  
 Fax: \_\_\_\_\_  
 E-mail: \_\_\_\_\_

**Ship to (If Different Than Above)**  
 Name: \_\_\_\_\_  
 Company: \_\_\_\_\_  
 Address: \_\_\_\_\_  
 City, State, Zip: \_\_\_\_\_  
 Phone: \_\_\_\_\_

**LATERAL RAIL**

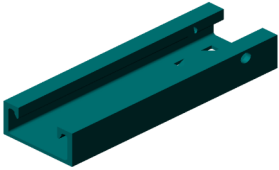

PART NO.	PRICE	QTY.
	EACH	
LRFA-6	\$ 4.00	

**LATERAL RAIL EXTENSION**

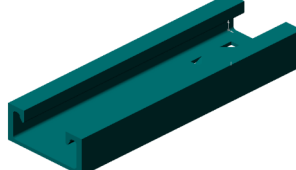

PART NO.	PRICE	QTY.
	EACH	
LR-X (IN)		
LR-6	\$ 9.00	
LR-12	\$ 12.00	

**FINE ADJUSTMENT BRACKET**

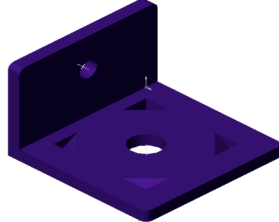

PART NO.	PRICE	QTY.
	EACH	
FABT	\$ 5.00	

**FINE ADJUSTMENT BRACKET**

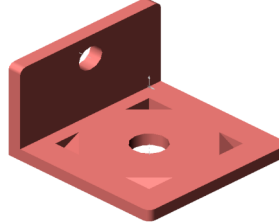

PART NO.	PRICE	QTY.
	EACH	
FABH	\$ 5.00	

**STRUT NUT HARDWARE KIT**



HEX HEAD SCREW  
5/16-18 x 3/4 LG.  
5/16 WAVY WASHER

PART NO.	PRICE	QTY.
	EACH	
SN-HW	\$ 1.00	

**SENSOR ADAPTOR**

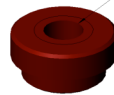

"X" TAP THRU

PART NO.	PRICE	QTY.
	EACH	
RBH-X (mm)		
SA-8x1.25	\$ 25.00	
SA-10x1.50	\$ 25.00	
SA-12x1.75	\$ 25.00	
SA-20x2.50	\$ 25.00	
*SA-XX		

**SENSOR ADAPTOR SPACER**



PART NO.	PRICE	QTY.
	EACH	
SAS	\$ 1.00	

**SENSOR ADAPTOR WASHER**



"X" HOLE DIAMETER

PART NO.	PRICE	QTY.
	EACH	
FLW-X (mm)		
FLW-8	\$ 1.50	
FLW-10	\$ 1.50	
FLW-12	\$ 1.50	
FLW-20	\$ 1.50	

**FINE ADJUSTMENT HARDWARE KIT**

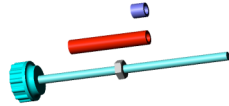

PART NO.	PRICE	QTY.
	EACH	
RTBS-HW	\$ 2.50	
RTBL-HW	\$ 2.50	

**FLAT BRACKET**



PART NO.	PRICE	QTY.
	EACH	
FBH-SA	\$ 4.00	

**STRUT NUT**



PART NO.	PRICE	QTY.
	EACH	
SN-00	\$ 4.00	

**MOUNTING RAIL**

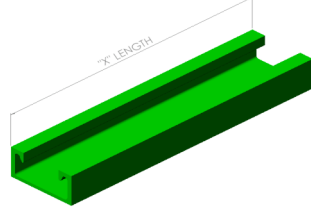

Longer lengths are available.

PART NO.	PRICE	QTY.
	EACH	
MR-X (in)		
MR-12	\$ 9.00	
MR-24	\$ 12.00	
MR-36	\$ 16.00	
MR-48	\$ 20.00	
MR-60	\$ 25.00	